



THE SCOTTSDALE

RESORT AT MCCORMICK RANCH





TABLE OF CONTENTS



“AT THE CROSSROADS OF EVERYTHING SCOTTSDALE”

“OFF THE BEATEN PATH. AT THE EPICENTER OF EVERYTHING SCOTTSDALE.”

Ideally located in the heart of Scottsdale, the AAA Four-Diamond Scottsdale Resort's hacienda-inspired décor and award-winning service offers the best in luxury travel for Scottsdale vacations. Renew your spirits at the Luna Spa, unwind by relaxing poolside, golf on adjacent 36-hole championship courses, or burn off extra energy in our fitness center. You'll find delectable cuisine at each of our three dining spots: Kitchen West Restaurant, Bar Six40 and Twisted Vine Pool Bar & Grill.

A wide-angle photograph of a hotel room. On the left is a large bed with a dark wood headboard and a patterned bedspread. In the center is a small round table with two chairs. To the right is a desk with a large TV and an office chair. A large window in the background shows an outdoor pool and a golf course.

Inspired by the warmth of local haciendas, the stunning décor throughout our 326 spacious guest rooms and suites invite relaxation. Whether poolside with lush views of McCormick Ranch Golf Course and the McCormick pool or within the secluded intimacy of our Suites and second-floor balcony rooms overlooking the tranquil Stillman pool and McCormick Ranch Golf Course, AAA Four Diamond amenities envelop guests in comforting luxury.





Kitchen West Restaurant is a lively eating, drinking and gathering place offering satisfying western American fare and views of the golf course. Executive Chef Rick Dupere utilizes the best local ingredients to create a seasonal menu that is whimsical, fun and truly delicious. Open for breakfast, lunch, dinner. The restaurant is casual and modern with a vibrant open kitchen and wood-fire grill. A selection of regional wines, craft beers and seasonal cocktails shine a spotlight on the local wine-making, brewing and distilling scene.

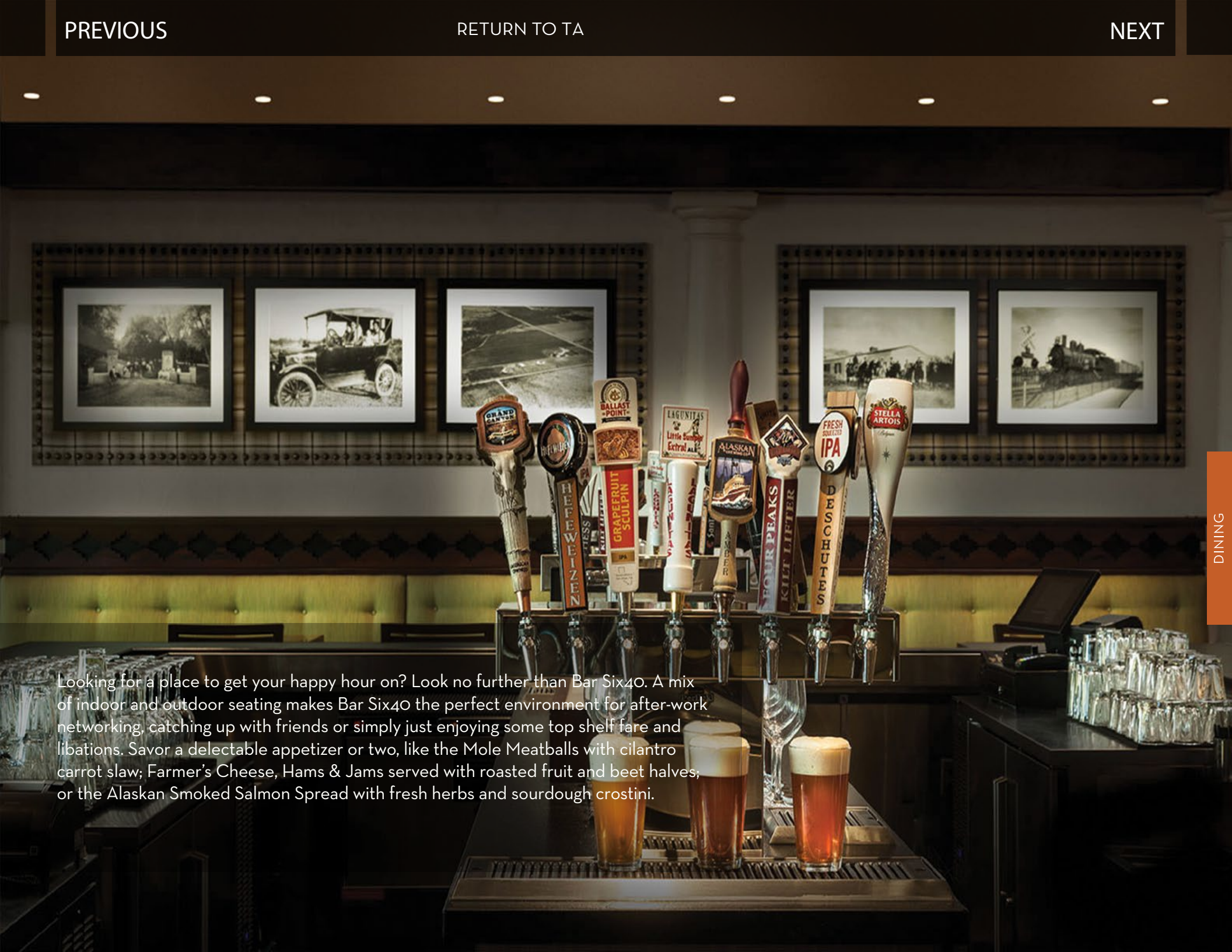

Looking for a place to get your happy hour on? Look no further than Bar Six40. A mix of indoor and outdoor seating makes Bar Six40 the perfect environment for after-work networking, catching up with friends or simply just enjoying some top shelf fare and libations. Savor a delectable appetizer or two, like the Mole Meatballs with cilantro carrot slaw; Farmer's Cheese, Hams & Jams served with roasted fruit and beet halves, or the Alaskan Smoked Salmon Spread with fresh herbs and sourdough crostini.

Built with meetings in mind, our expertise is reflected in the layouts and designs of our spaces. Our facilities feature 50 versatile meeting rooms offering you the most appropriate and inspiring setting for your program - from a conference suite for ten, to the dramatic 10,000 square foot Grand Coronado Ballroom.



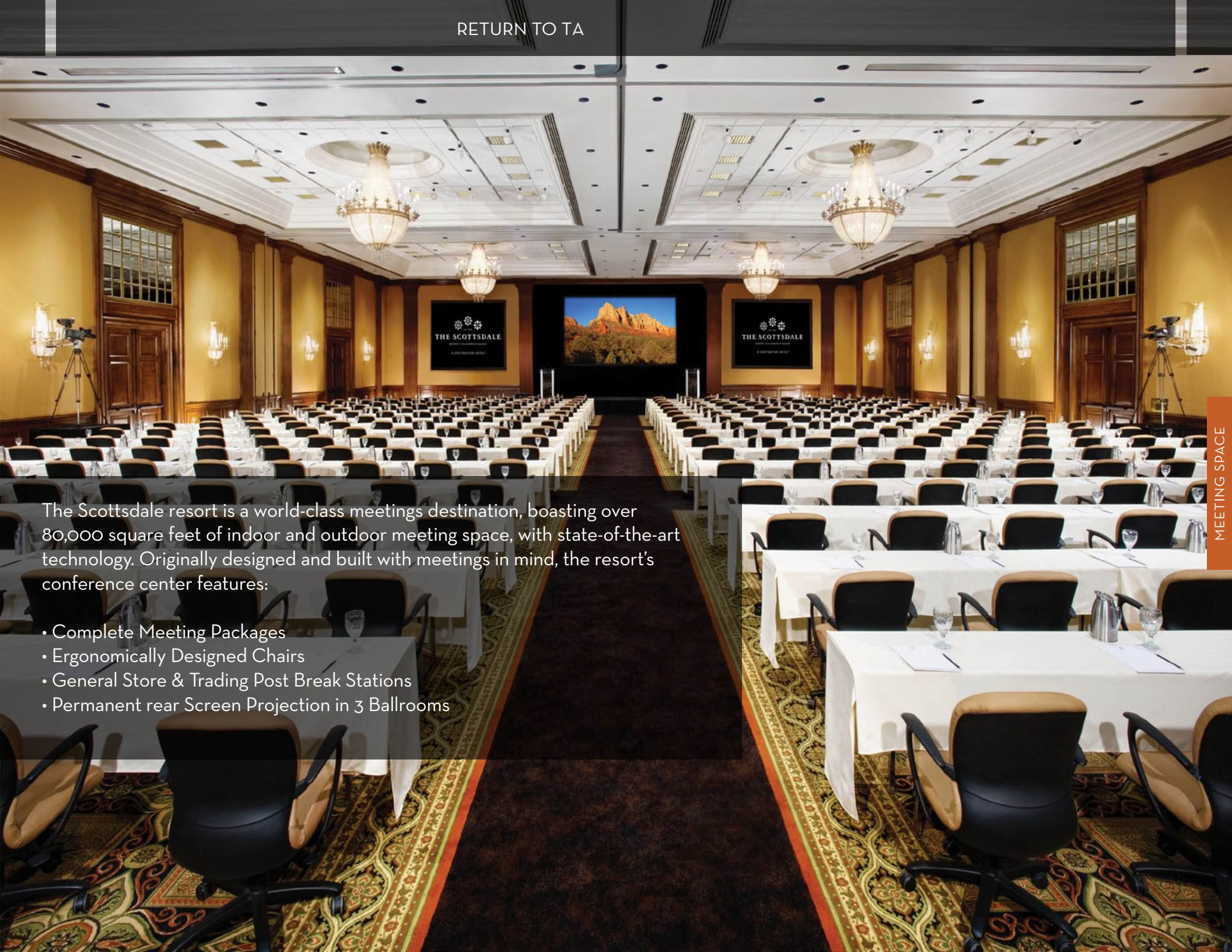

The Scottsdale resort is a world-class meetings destination, boasting over 80,000 square feet of indoor and outdoor meeting space, with state-of-the-art technology. Originally designed and built with meetings in mind, the resort's conference center features:

- Complete Meeting Packages
- Ergonomically Designed Chairs
- General Store & Trading Post Break Stations
- Permanent rear Screen Projection in 3 Ballrooms

FLOOR PLAN

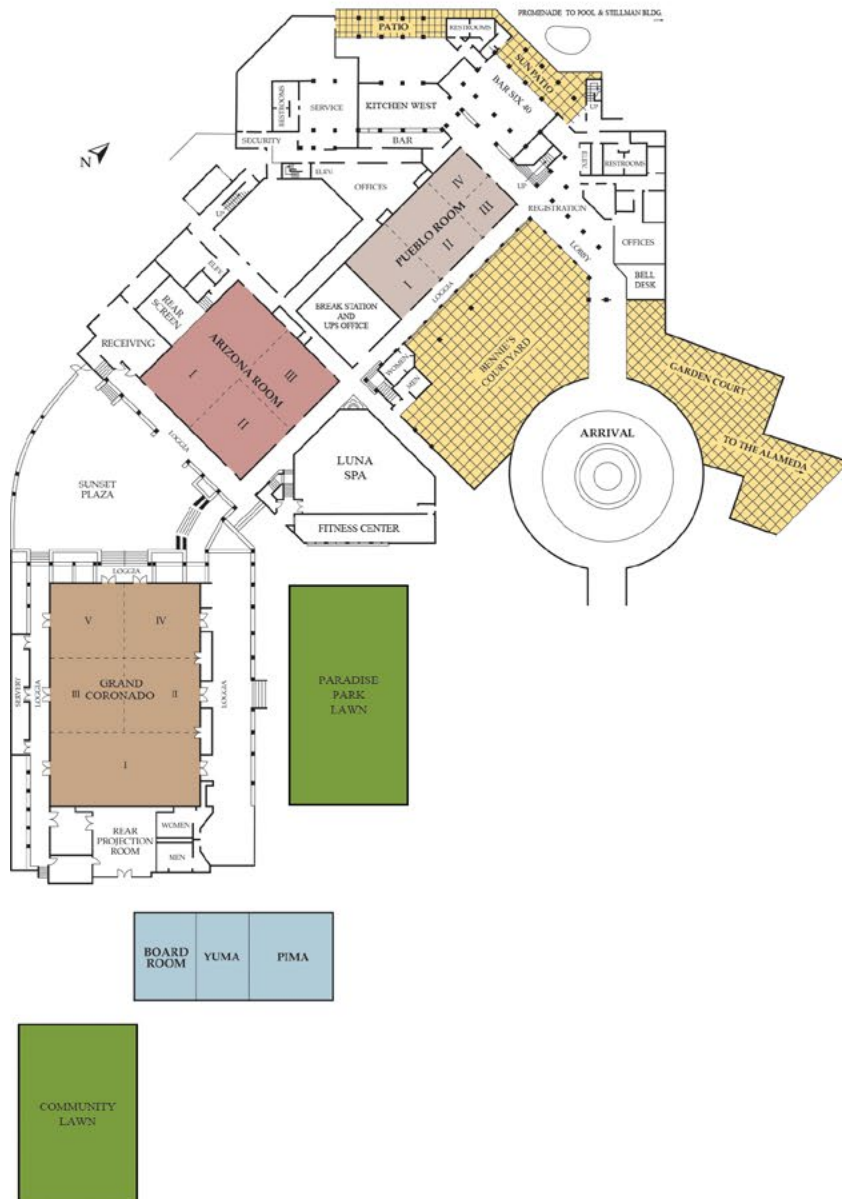

CAPACITY CHART

Garden Level	<i>Dimensions</i>	<i>Sq. Feet</i>	<i>Theatre</i>	<i>Schoolroom</i>	<i>U-Shape</i>	<i>Banquet</i>
Grand Coronado 120x80		10,000	1,000	640	N/A	700
<i>Ceiling Height - 22' Soffit 20'</i>						
I	40x80	3,200	324	144	76	210
II	40x40	1,600	144	70	36	90
III	40x40	1,600	144	70	36	90
IV	40x40	1,600	144	70	36	90
V	40x40	1,600	144	70	36	90
Arizona	78x78	6,084	660	308	88	420
I	78x39	3,042	264	132	80	180
II	39x39	1,521	120	77	36	90
III	39x39	1,521	120	77	36	90
II & III	78x39	3,042	248	132	80	180
Pueblo	89x41	3,649	432	240	84	240
I	31x41	1,271	108	64	30	80
II	31x41	1,271	108	64	30	80
III & IV	27x41	1,107	96	36	24	70
III	27x20	540	50	21	18	30
IV	27x21	567	50	21	18	30
Boardroom	39x29	1,131	84	48	28	80
Pima	49x39	1,911	180	70	36	120
Yuma	29x30	870	50	32	22	40
Bennie's Courtyard	-	-	-	-	-	380
Sunset Plaza	-	-	-	-	-	350
McCormick Pool	-	-	-	-	-	700
Stillman Pool	-	-	-	-	-	330
The Alameda	-	-	-	-	-	600
Garden Court	-	-	-	-	-	60
Paradise Park Lawn	-	-	-	-	-	500
Community Lawn	-	-	-	-	-	250

FLOOR PLAN

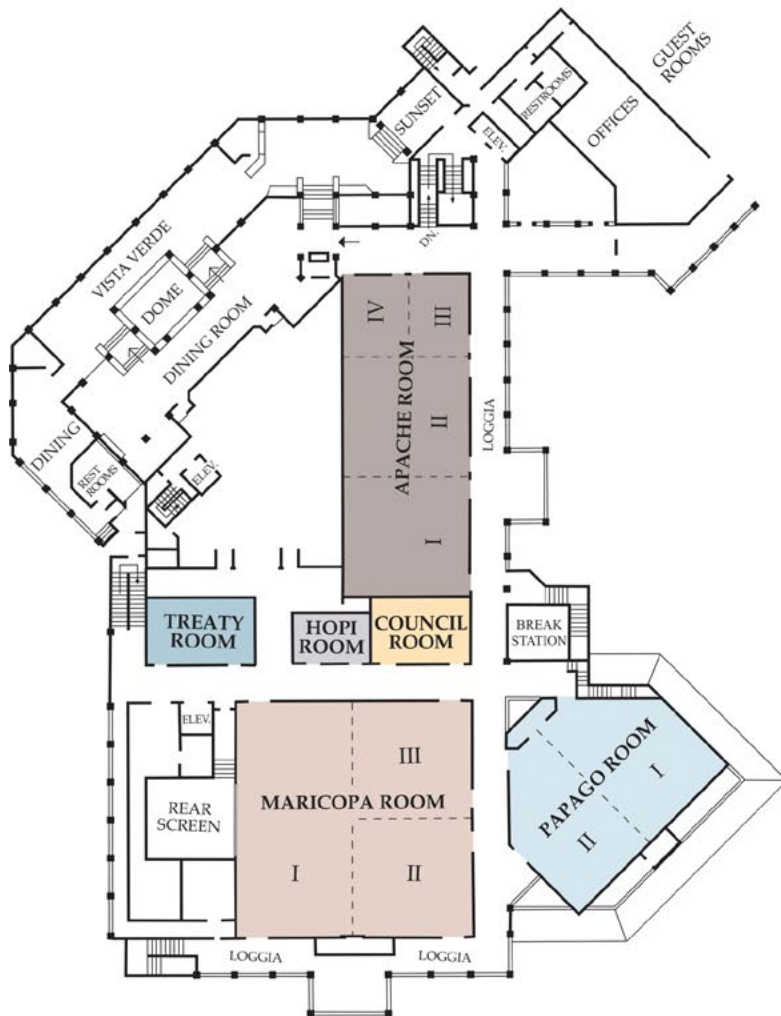

CAPACITY CHART

Third Level

	<i>Dimensions</i>	<i>Sq. Feet</i>	<i>Theatre</i>	<i>Schoolroom</i>	<i>U-Shape</i>	<i>Banquet</i>
Maricopa	78x78	6,084	660	308	88	420
I	78x39	3,042	264	132	80	180
II	39x39	1,521	120	77	36	90
III	39x39	1,521	120	77	36	90
II & III	78x39	3,042	248	132	80	180
Papago	66x40	2,640	220	144	52	190
I	33x40	1,320	110	60	24	80
II	33x40	1,320	110	60	24	80
Apache	105x41	4,305	480	272	84	270
I	39x41	1,599	124	64	30	90
II	39x41	1,599	124	64	30	90
III & IV	27x41	1,107	96	36	24	70
III	27x20	540	50	18	18	30
IV	27x21	567	50	18	18	30
Council	31x21	651	48	30	20	40
Treaty	33x21	693	48	30	20	40
Hopi	21x14	294	16	9	N/A	10

18 Conference Suites of varying sizes accomodating 10 - 20

THE SCOTTSDALE RESORT AT MCCORMICK RANCH PREFERRED PARTNERS:

AUDIO VISUAL



DMC



PRINTING , SHIPPING AND RECEIVING



TRANSPORTATION





THE SCOTTSDALE

RESORT AT MCCORMICK RANCH

A DESTINATION HOTEL®

7700 E MCCORMICK PARKWAY, SCOTTSDALE, AZ 85258
THESCOTTSDALERESORT.COM